

# IP65 LED Panel Light Specifications

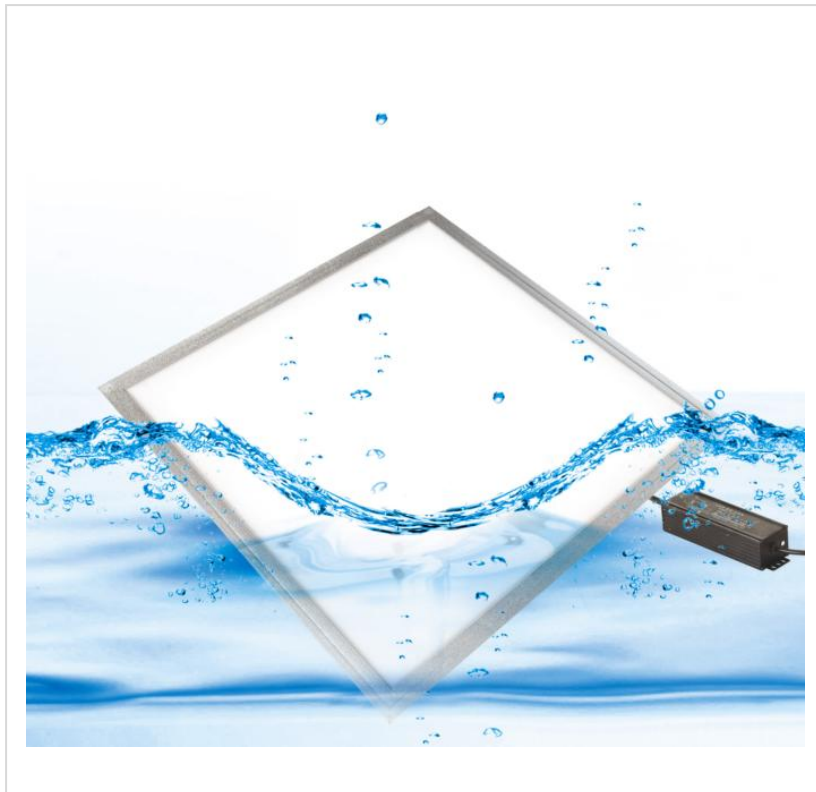

**Product Name:** IP65 LED Panel Light

**Product Model:** PL0606/PL1203-WXXW

**Release Date:** 2016-12-30

**Edition NO.:** V1.0

## 1.General introduction

### Product features:

- 1 : Two waterproof rings are sealed into light body. Good environment silicone rubber sealing outlet and hole of cable and screw ,and other gap.
- 2 : IP67 LED driver, silicone wire waterproof ,female connector. The complete light can meet IP65 standard.
- 3 : Lifespan 50000hrs

### Product photo show

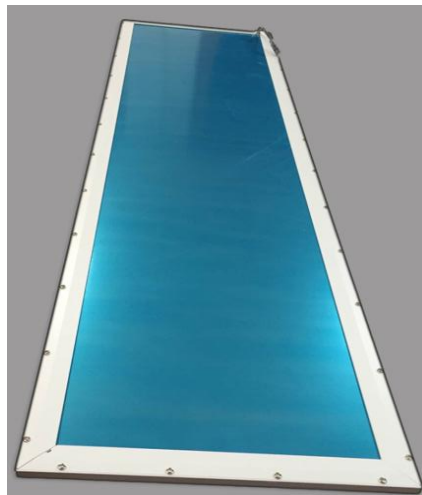

### Application scenarios

1. IP65 LED Panel light be used outdoor and high humidity, or dusty environments lighting place.  
such as : bath room, underground parking and other lighting with water and high humidity .

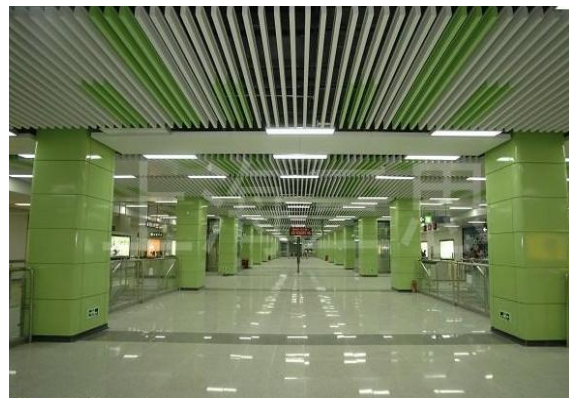
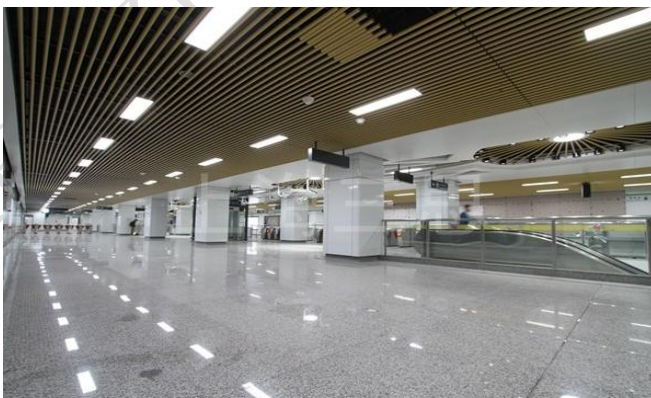

## 2.Product technical parameters

Classify	Model	PL0606-W36W	PL0606-W40W	PL1203-W36W	PL1203-W40W
	Item				
structure	Product material	AL+PMMA+PS	AL+PMMA+PS	AL+PMMA+PS	AL+PMMA+PS
	Protection class	IP65	IP65	IP65	IP65
	Product Weight	3.9Kg	3.9Kg	4.25Kg	4.25Kg
	Product size	595*595*13mm		1195*295*13mm	
Electric power source	Input Voltage	AC85-277V			
	Power Consumption	36W	40W	36W	40W
	Power efficiency	88%	89%	88%	89%
	Power Factor	0.95	0.95	0.95	0.95
	Operating Frequency	50/60HZ			
	Power protection features	IP65 , With over-temperature, over-current, overload protection function			
LED optical	LED Type	SMD 2835			
	CRI	Ra>80			
	CCT	3000/4000/6000K			
	Luminous efficiency	>100lm/W@6000K			
Operating temperature		-20°C~+55°C			
Operating humidity		10%~90%			
Storage temperature		-20°C~80°C			
Lamp life		50000Hrs			
Warranty		3 years			
Lamp Type		<input type="checkbox"/> class I <input type="checkbox"/> class II <input checked="" type="checkbox"/> class III			
Certification		CE & RHOS			

Table1 technical parameter

### Outline Dimensions (Unit: mm )

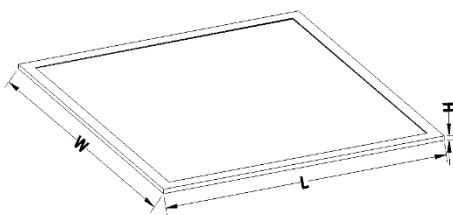

Model	L	W	H
PL0606-W36W	595	595	13
PL0606-W40W	595	595	13
PL1203-W36W	1195	295	13
PL1203-W40W	1195	295	13

### LED light photics diagram

For example :36W

LUMINOUS INTENSITY DISTRIBUTION

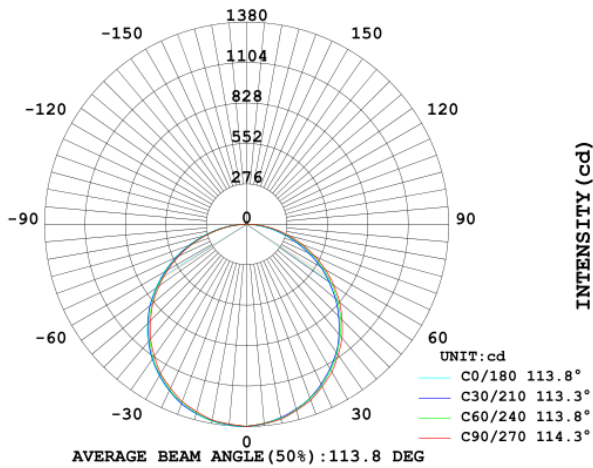

LUMINOUS INTENSITY DISTRIBUTION

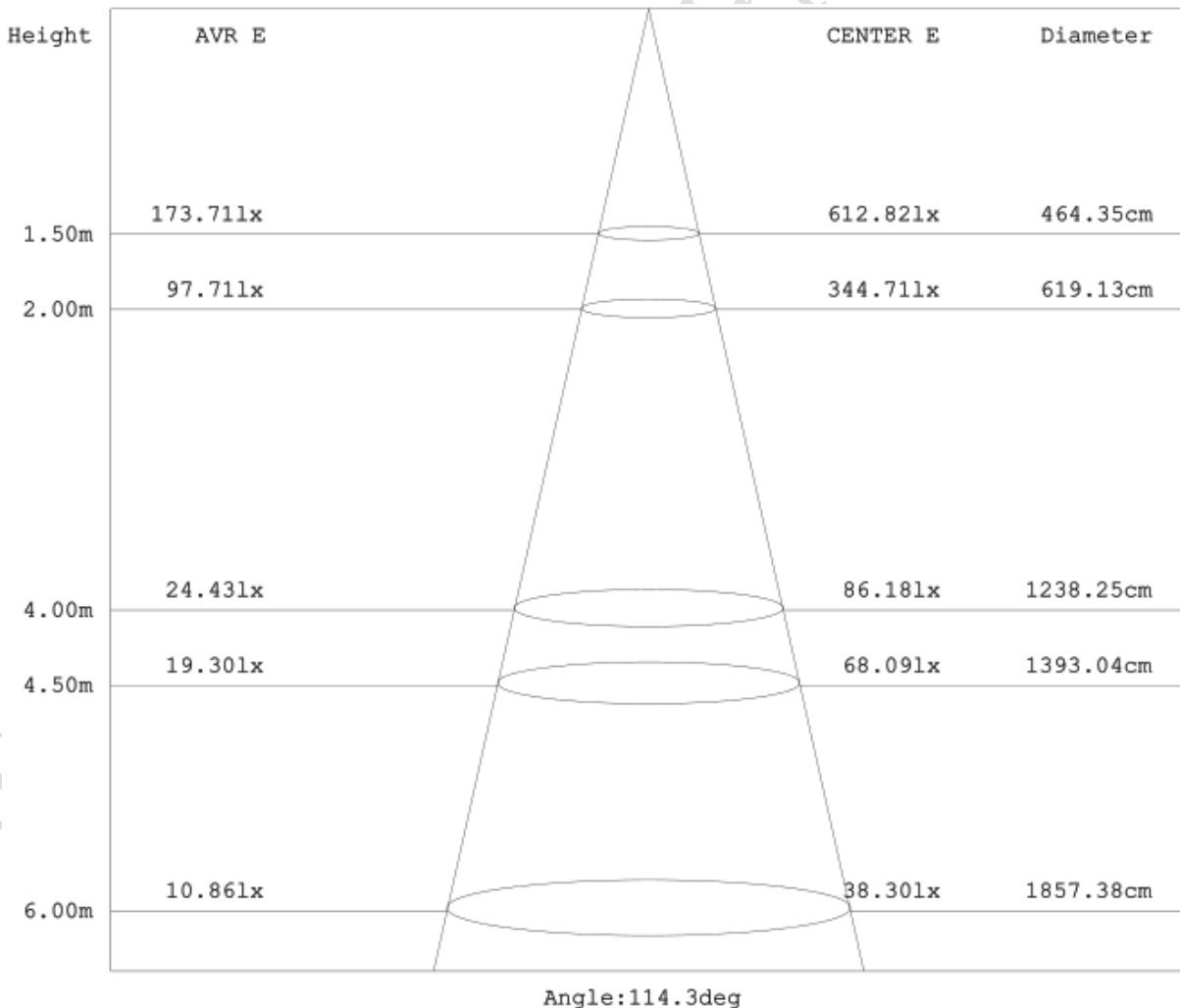
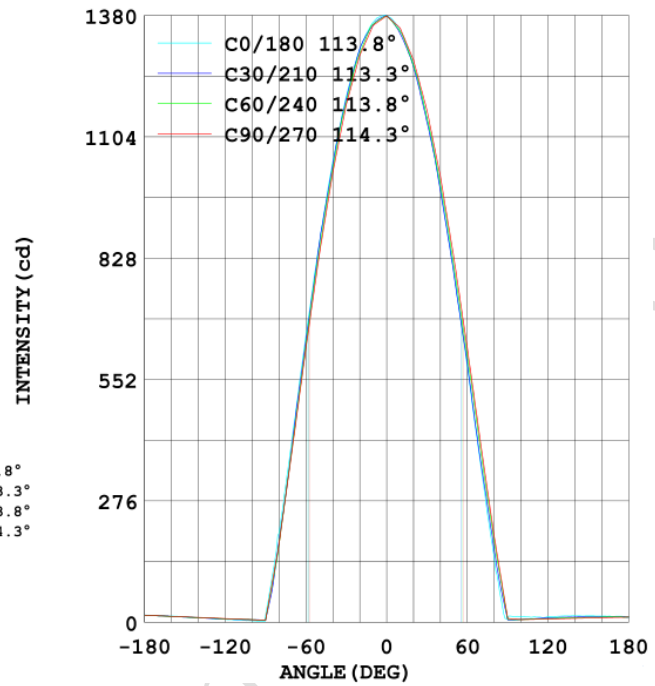

## Installation

### ◇ Suspended type is optional

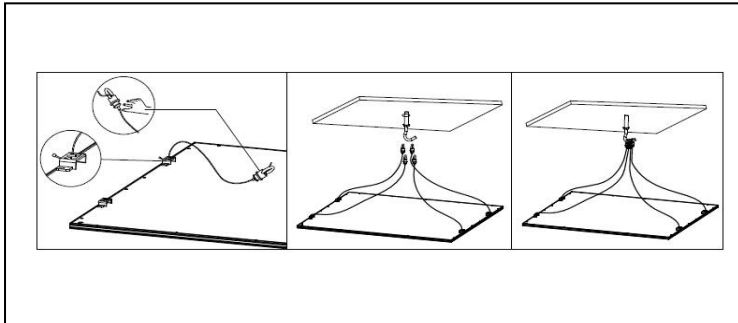

#### Steps:

1. Fixed one end of the stainless steel onto the ceiling with anchor bolt.
2. Fixed the other end of stainless steel into the back cover of LED panel light;

### ◇ Recessed optional

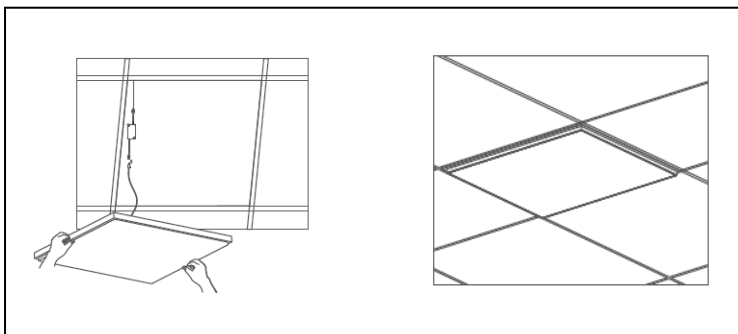

#### Steps:

1. Take off the false ceiling panel, put in the panel from diagonal
2. Fix the panel at the right place

### ◇ Surface mounted is optional

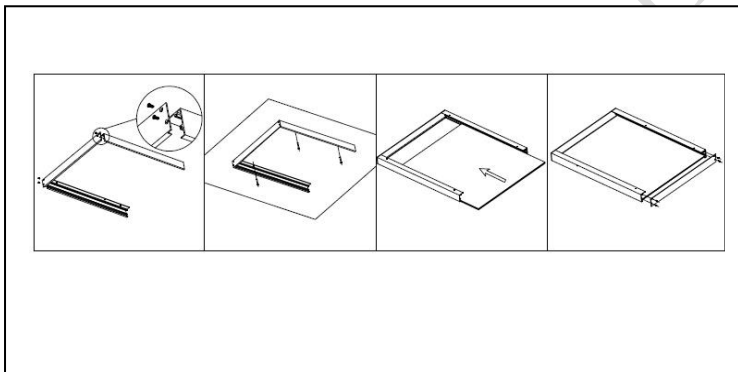

#### Steps:

1. Fix the surface box ,and then fix to the ceiling.
2. put the led panel light into the surface box .
3. fix the last box line.

## Operation

### Connection schematic drawing

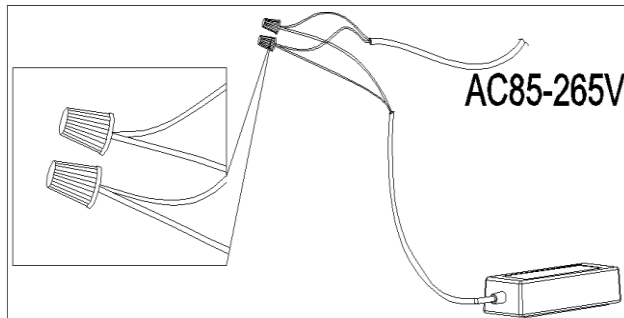

### Operation indication:

1. Check product items as checklist
2. Power off light
3. install panel light
4. Power on light

## Packing

One panel in an Inner box, one master carton contain 5 inner boxes

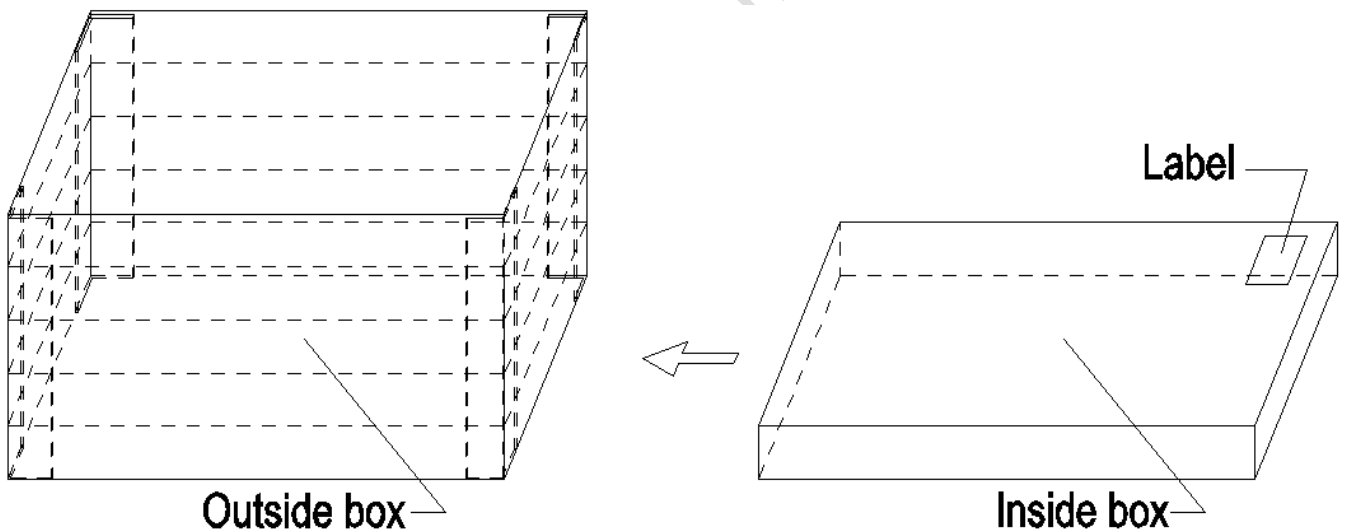

Packing details in box

SN	item	qty	remark
1	LED panel Light	1	
2	IP67 driver	1	
3	Fixture accessories	0-4	
4	Remoter		

### Shipment Size information

Item	Size/ Carton	G.W./ Carton
PL0303-WXXW	67*36*34cm/ctn	20PCS/CTN-22.0KGS
PL0603-WXXW	67*34*34cm/ctn	10PCS/CTN-21.0KGS
PL0606-WXXW	69.5*66.5*24.5cm/ctn	5PCS/CTN-22.0KGS
PL1203-WXXW	132.5*35.8*23.5cm/ctn	5PCS/CTN-23.25KGS

### Attention

1. In order to ensure proper operation, make sure that the voltage must be in indicated range
2. Follow the correct way to install and operate the product before installing or removing , need to power off to prevent electric shock
3. This product is waterproof, outdoor and high humidity, or dusty environments can use.
4. Product is not working in the frequent power-off state, it will affect the life of the light
5. Do not look directly into the LED light source, long, high-intensity light source may cause eye injury
6. No user dismantle, replace the device